

# How to use TytoClinic™



1

On the Express Care Online app, scroll to the bottom of the home screen and click **“Sign Up for Cleveland Clinic Express Care”**

Enter your personal details, and create a password.

If you already have an account, enter your login information.

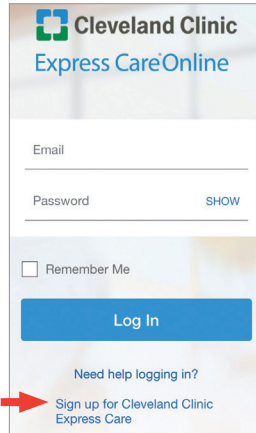

2

Under Service Key:

For **domestic** students, enter: **DOMSAGBC**

For **international** students, enter: **INTSAGBC**

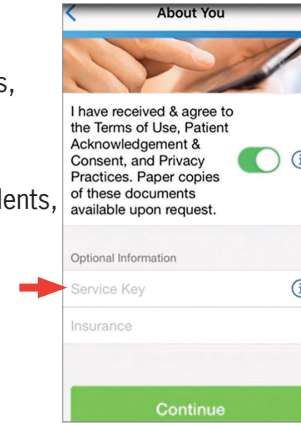

3

Once you're signed in, select **“George Brown College”**. You will see a page of available clinicians. Select the provider you want to see. You can also review bios of the clinicians by clicking on their names.

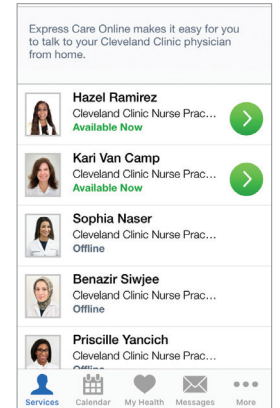

4

Once you've selected the provider, you'll see the **“Get Started”** page. Select who the visit is for, then click **“Continue”**.

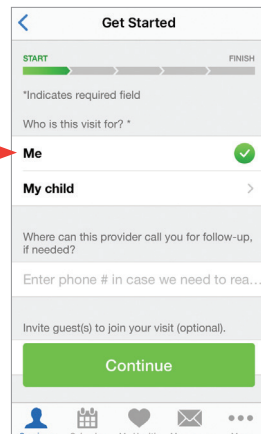

5

On the **“Your Visit”** page, type the reason for your visit. To connect to the Tyto device, click **“Set up a Tyto Device”**.

Next, please follow Steps 6-7 to pair the Tyto device to ensure an optimal virtual visit.

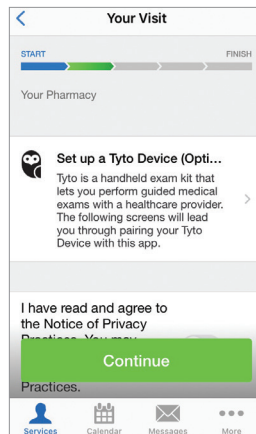

6

Take the Tyto kit out of the drawer. Turn on the Tyto device until you hear a chime. Click continue on the tablet when it prompts you to enter internet name and password.



Tyto device hub

On the Tyto device hub:

1. Touch the three dots (...) at top of screen
2. Choose connected green icon
3. Choose **connect to other WI-FI**
4. And choose **scan barcode**

7

Scan the QR code with your Tyto device to complete set-up.

Once your Tyto device is paired, you will see **“Congratulations. Tyto is now paired.”** on your screen.

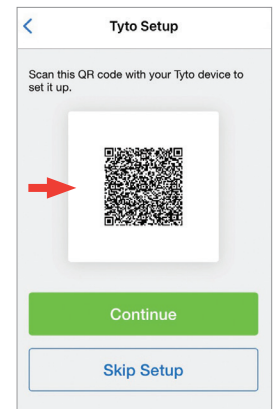

8

You must check the Notice of Privacy box. Then click **“Continue”**.

Once your Tyto device is set up, select **“Join Visit”** on your Tyto device.

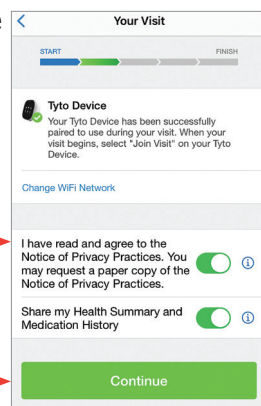

9

On your Tyto device, press **“Join online visit.”** After a short wait, you'll be able to connect live with your clinician.

Your Tyto exam will be conducted live with your clinician.

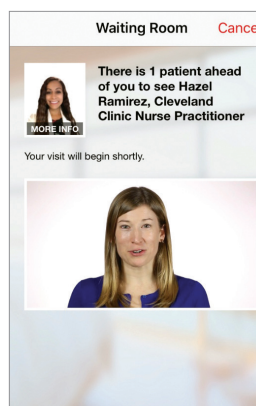

10

After your Tyto exam, follow the hygiene and sanitation instructions displayed in the clinic to clean the Tyto Device for the next use.

**Important:** Cleaning the unit thoroughly will help prevent the spread of germs and ensure that the virtual care clinic is ready for the next user.



11

Place the Tyto device into the tray and connect the charging cable to ensure it is ready for the next use. You will see an orange light on the front of the device when it is successfully charging.

